



# 'PE' COUPLINGS

- 'NMC' PE Coupling is mechanical pipe Coupling meant for plain end pipes. It comprises two flanges (MCI/DI) one central sleeves (M.S) two wedge section Rubber Rings one set of single spanner Zn-plated Bolt & Nut.
- Tightening of the bolts draws the flanges together compressing the sealing rings in gap between the sleeve and end flanges on to the pipe thus effecting a leak tight joint.
- Rubber Sealing Rings are available in Nitrile, EPDM, Viton, Silicon. They are available in quick fit (upto DN 300) and un-fit versions.



**for STEEL and IMPERIAL uPVC PIPE 38mm to 2020mm O.D.**

*Coupling for CI, DI, AC & other odd size pipes also available.*

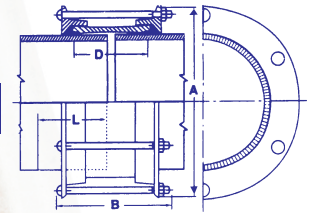

PIPE DIMENSIONS			COUPLING DIMENSIONS & DETAILS								
-----------------	--	--	-------------------------------	--	--	--	--	--	--	--	--

Norm Bore	Pipe O. D.	Tolerance on O.D. for Distance L	L	A	B	SLEEVE D x Average Thickness	PLUGS No. Off	BOLTS		Max. Test Pressure	Approx Weight
								No. Off	Dia x Length		
mm	mm In	mm	mm	mm	mm	mm			in	bar	kg
32	38	+ 0.8	100	111	152	80x5.5	1	2	0.5x5.50	70	1.50
32	44.5	+ 0.8	100	120	152	80x5.5	1	2	0.5x5.50	70	1.50
40	48.3	+ 0.8	100	122	152	80x5.5	1	2	0.5x5.50	70	1.90
50	60.3	+ 0.8	100	136	152	80x5.5	1	2	0.5x5.50	70	2.20
65	73	+ 0.8	100	152	170	100x6.0	1	2	0.5x5.75	70	2.80
65	76.1	+ 0.8	100	152	170	100x6.0	1	2	0.5x5.75	70	2.80
80	88.9	+ 0.8	100	163	170	100x6.0	1	3	0.5x6.25	70	4.00
90	101.6	+ 0.8	100	176	170	100x6.0	1	4	0.5x6.25	70	5.20
100	108	+ 0.8	100	187	170	100x6.0	1	4	0.5x6.25	70	5.30
100	114.3	+ 0.8	100	195	170	100x6.0	1	4	0.5x6.25	70	5.50
100	127	+ 0.8	100	204	170	100x6.0	1	4	0.5x6.25	70	5.90
125	139.7	+ 1.6	100	226	170	100x6.6	1	4	0.5x6.25	65	6.50
125	141.3	+ 1.6	100	226	170	100x6.6	1	4	0.5x6.25	65	6.50
150	152.4	+ 1.6	100	237	170	100x6.6	1	4	0.5x6.25	60	7.80
150	165.1	+ 1.6	100	251	170	100x6.6	1	4	0.5x6.25	55	8.00
150	168.3	+ 1.6	100	255	170	100x6.6	1	4	0.5x6.25	55	8.00



# 'PE' COUPLINGS



PIPE DIMENSIONS			COUPLING DIMENSIONS & DETAILS								
Norm Bore	Pipe O. D.	Tolerance on O.D. for Distance L	L	A	B	SLEEVE D x Average Thickness	PLUGS No. Off	BOLTS		Max. Test Pressure	Approx Weight
mm	mm In	mm	mm	mm	mm	mm		No. Off	Dia x Length in	bar	kg
200	219.1 8.625	+ 1.6 - 0.8	100	310	170	100x6.6	1	5	0.5x6.25	50	8.00
225	244.5 9.625	+ 1.6 - 0.8	100	332	170	100x6.6	2	6	0.5x6.25	50	14.00
250	273 10.750	+ 1.6 - 0.8	100	362	170	100x6.6	2	6	0.5x6.25	50	16.10
300	323.9 12.750	+ 1.6 - 0.8	100	414	170	100x7.0	2	6	0.5x6.25	45	19.0
350	355.6 14.000	± 1.6	125	443	227	150x7.7	2	6	0.5x6.50	35	24.0
400	406.4 16.000	± 1.6	125	494	227	150x8.5	2	6	0.5x8.50	35	30.0
450	457 18.000	± 1.6	125	545	227	150x8.5	3	8	0.5x8.50	35	38.0
500	508 20.000	± 1.6	125	595	227	150x8.5	3	10	0.5x8.50	35	43.0
550	559 22.000	± 1.6	125	646	227	150x9.0	3	10	0.5x8.50	35	50.0
600	610 24.000	± 1.6	125	697	227	150x9.0	3	10	0.5x8.50	35	55.0
650	660 26.000	± 1.6	125	748	227	150x9.0	3	12	0.5x8.50	35	58.0
700	711 28.000	± 1.6	125	799	227	150x9.0	3	12	0.5x8.50	30	63.0
750	762 30.000	± 1.6	125	849	227	150x9.0	3	12	0.5x8.50	30	66.0
800	813 32.000	± 1.6	125	900	227	150x9.0	3	14	0.5x8.50	25	76.0
850	864 34.000	± 1.6	125	951	227	150x9.0	3	14	0.5x8.50	25	83.0
900	914 36.000	± 1.6	125	1002	227	150x9.0	3	14	0.5x8.50	25	90.0
1000	1016 40.000	± 1.6	150	1125	260	178x9.0	3	14	0.625x9.75	25	105
1050	1067 42.000	± 1.6	150	1176	260	178x9.0	3	14	0.625x9.75	25	110
1100	1118 44.000	± 1.6	150	1227	260	178x9.0	3	14	0.625x9.75	25	115
1200	1219 48.000	± 1.6	150	1344	280	178x11.1	3	16	0.625x10.50	25	150
1400	1420 55.906	+ 1.6 - 3.2	150	1545	280	178x11.1	3	20	0.625x10.50	25	180
1800	1820 71.654	± 3.2	150	1945	280	178x11.1	3	28	0.625x10.50	25	230
2000	2020 79.528	± 3.2	200	2154	413	254x14.3	3	26	0.625x15.75	25	430

13/61/08